

Flymap

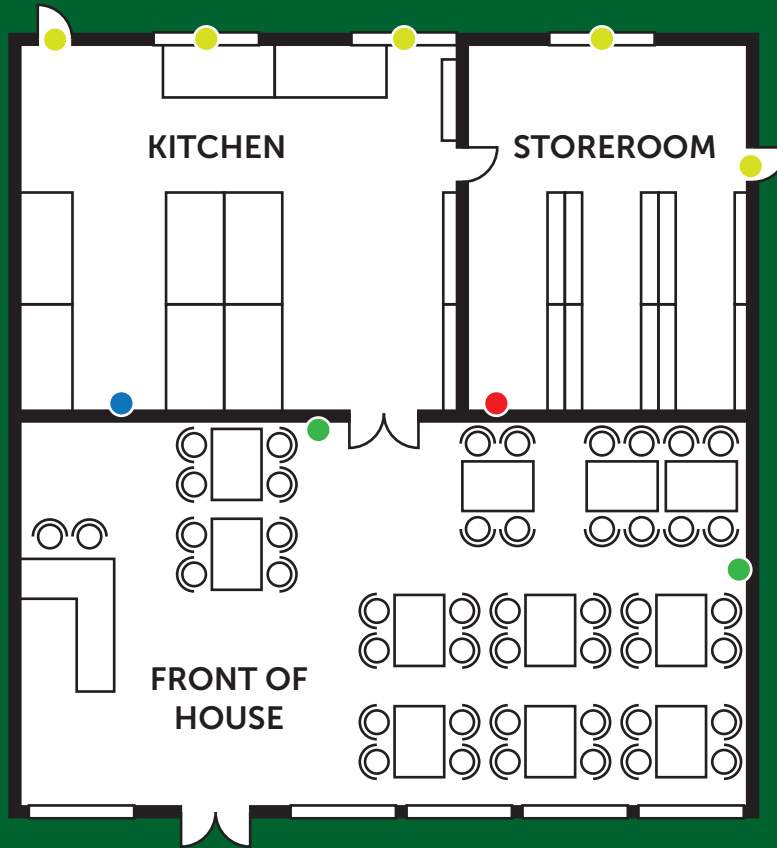

INSECT CONTROL

- Killing Grid - Storeroom / Backroom
- Glueboard - Kitchen / Sensitive area
- Decorative - Front of house
- Preventative - External protection

Kitchen

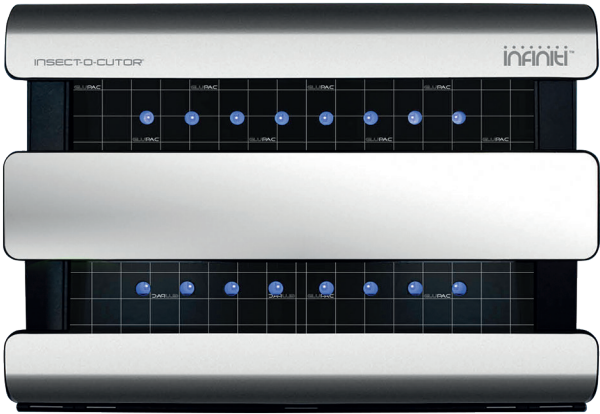

Infiniti 2

Infiniti is the ultimate choice for a wide range of commercial applications, with additional benefits including the ultra slim profile and bottom loading glueboard which make the unit perfect for areas lacking in wall space.

UV LED source, offers 67% savings in energy running costs!

- Unique positioning of the UV LEDs behind the glueboard, for improved catch.
- Glueboard access from the bottom for quick and easy servicing
- Low energy running costs
- Compact model for discretion and space restricted installations
- Quick tool free access gives simple access to consumables for easy maintenance
- High efficacy UV LED strips provide a 3 year effective life
- Removable lure tray for liquid attractant
- Designed for use with Glupac® glueboards with UV stabiliser
- Independently tested and certified to RoHS and all relevant European standards

INFINITI-UK	1106000155
-------------	------------

Halo

Halo can be vertically or horizontally wall mounted, or desk mounted* using the specially designed desk mounting feet. The compact 15W unit can even be discreetly mounted above doors for areas where space is restricted.

- Commercial efficacy with a contemporary discreet aesthetic for a wide range of applications
- Side access to glueboard for quick and easy servicing
- Aluminium removable debris tray
- Adjustable light apertures for maximum light output or prevention of dust ingress
- Compact 15W model for space restricted installations
- Quick tool free access gives simple access to consumables for easy maintenance
- High efficacy UV tubes
- Designed for use with Glupac® glueboards with UV stabiliser
- 45W IP Aqua model available for hose down and sensitive areas
- Independently tested and certified to RoHS and all relevant European standards
- Tubes: 1 / 2 / 3 x TPX15-18
- Glueboard: 1 x GB012
- Suggested area coverage: 40 / 80 / 120m²

HL15	1106000658
HL30	1106000660
HL45	1106000731

Storeroom

Plus-Zap

The third generation PlusZap model offers up to 35% reduction in energy consumption cost* and is 20mm slimmer in design saving on space when installed. In addition, the power cable is now hardwired, improving usability. The PlusZap features staggered lamps to create efficient UV light output whilst the killing grid offers an effective catch area with easy servicing making it ideal for commercial environments.

- Slim and discreet design
- Pre-installed powerful UV lamps to attract flies
- Robust aluminium and UV stable plastic construction
- Staggered lamps to create efficient UV light output
- Three simple to install mounting options for wall, desk or ceiling suspension
- Catch tray is simple to remove for quick and safe maintenance, with anti-blow out folds

PZ3-16AL	1106004061
PZ3-30AL	1106004062
PZ80S	1106000803



Exocutor

The Exocutor brand has been a favourite with specifiers for over 20 years, selected for its longstanding reliability and proven efficacy in demanding commercial environments. Available in a stainless steel or white finish,

- Unique corner light scoops give increased UV light output
- Internal aluminium UV light reflectors
- Staggered, high efficacy UV tubes for increased efficacy
- Reliable high specification 3,750V transformer
- Unique triangular killing grid for a larger effective catch area
- Strong UV stable polycarbonate and coated mild steel / stainless steel construction
- Large capacity, mains interlocked catch tray with anti-blow out folds
- Simple wall, ceiling or desk mounting
- Easy cleaning and servicing
- Range of spare parts available
- Independently tested and certified to RoHS and all relevant European standards
- Contemporary market leading British design
- Tubes: 2 x TPX15-18
- Suggested area coverage: 100m²

EX80S	1106000723
EX80W	1106000724
EX30S	1106000654
EX30W	1106000655
EX16S	1106000653
EX16W	1106000811



Decorative -

Front of house

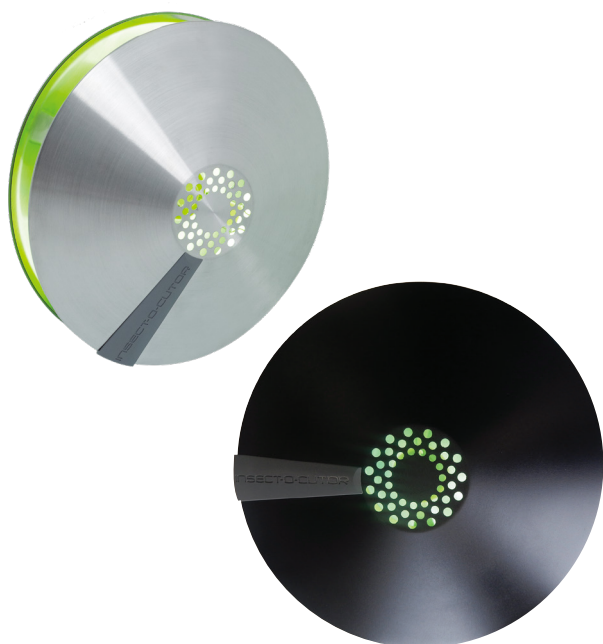

Aura or Aura Black

A stylish and contemporary decorative flykiller, Aura is an ultra discreet unit designed for front-of-house applications. Ideal for use within cafes, restaurants, bars and hotels. The unique circular registered design of the unit allows light to attract flying insects from a full 360° around the unit

- Beautifully polished facade
- Slim design ensures that the unit is unobtrusive
- Ultra discreet fly catching glueboard hidden from view
- 100% useful glueboard area ensures maximum efficacy
- Ensures compliance with food hygiene legislation and protects clientele from flying pests
- Dual wavelength Synergetic® technology for an increased catch
- Easy tool free access and efficient servicing
- Quick and simple IEC mains socket • Robust stainless steel and UV stable polycarbonate construction
- Tubes: 1 x TGX22
- Glueboard: 1 x INL198
- Suggested area coverage: 40m²

ZL051-BLACK	1106000708
ZL051	1106000707

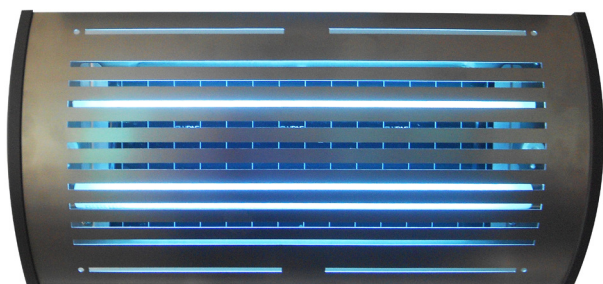

Halo Curve

The elegant shaped facade is punctuated by stylish detailing, hiding caught flies from the view of customers in restaurants, hotels, cafes and bars, and finished with cobalt grey UV stable polycarbonate edging.

- Elegant detailing and slim decorative design
- Part of the co-ordinated Insect-O-Cutor Halo® range
- Discreet fly catching glueboard hidden from view
- Horizontal or vertical mounting
- Quick and simple IEC mains socket, or discreet hard wiring option
- Easy tool free access and efficient servicing
- High efficacy UV tubes
- Designed for use with Glupac® glueboards with UV stabiliser with UV stabiliser
- Independently tested and certified to RoHS and relevant European standards
- Tubes: 2 x TPX15-18
- Glueboard: 1 x GB005
- Suggested area coverage: 60m²

HLCURVE	1106000820
---------	------------

Luralite Cento

A compact and discreet solution, Luralite® Cento is ideal for front of house areas, including bars, cafes and restaurants.

- Ideal for front of house applications
- Simple glueboard and tube replacement
- High efficacy UV tubes
- Designed for use with Glucpac® glueboards with UV stabilizer
- Robust Construction
- Independently tested and certified to RoHS and relevant European standards
- Tubes: 1 x TPX18
- Glueboard: 1 x INL118
- Suggested area coverage: 25m²

ZL011

1106000705



Flyscreens

What we offer:

Surveying and fitting across the whole of the UK

- Five year manufacturing and installation guarantee
- 40 years of surveying, manufacturing and installation expertise
- Dedicated flyscreen customer service team and field experts on hand to advise
- All screens manufactured off site at our dedicated manufacturing warehouse to ensure minimal disruption to your clients
- Experts in bespoke and complex jobs
- All our screens provide compliance with the food safety regulations 2004
- Available in specific RAL colours and different types of mesh on request
- Available as supply only or supply and fit

Preventative – Flyscreen

